

How to Order RW Series Regulator

The RW Series regulator consists of 2 modules, the body and the flowmeter, which are threaded together to form the complete regulator. To order it is necessary to SELECT and SPECIFY the features desired on each module. The B-Regulator, RW Code is used to identify and select these features. Begin with the body. Move across the list of options, select one from each section, and specify the code for that option. When finished, you will have an assembly number such as **RR800**. This number, for example identifies a:

- D** - RW Series Regulator
- R** - Right Hand Body w/ 1.4" 0-3000 PSI Gauge w/Boot @ 300 degrees
- 8** - CGA 870 Yoke inlet connection, w/ Default Green anodized color
- 0** - No Pressure Body Outlets
- 0** - No Body Options
- _** - Color Option (if none use default)

Now move to the Flowmeter. Following the same procedure will produce an assembly number such as **300P4**. This number, for example identifies a:

- 3** - Small Diameter Knurled Knob
- 0** - Window @ 0 degrees & Hose Barb @ 180 degrees
- 0** - No Flow Cartridge Options
- _** - Color Option (if none use default)
- P4** - 0 thru 25 LPM flow range (see B-Flows.xlsx)

Combining the two assembly numbers will provide a complete regulator part number such as **RR800-7003P4**.

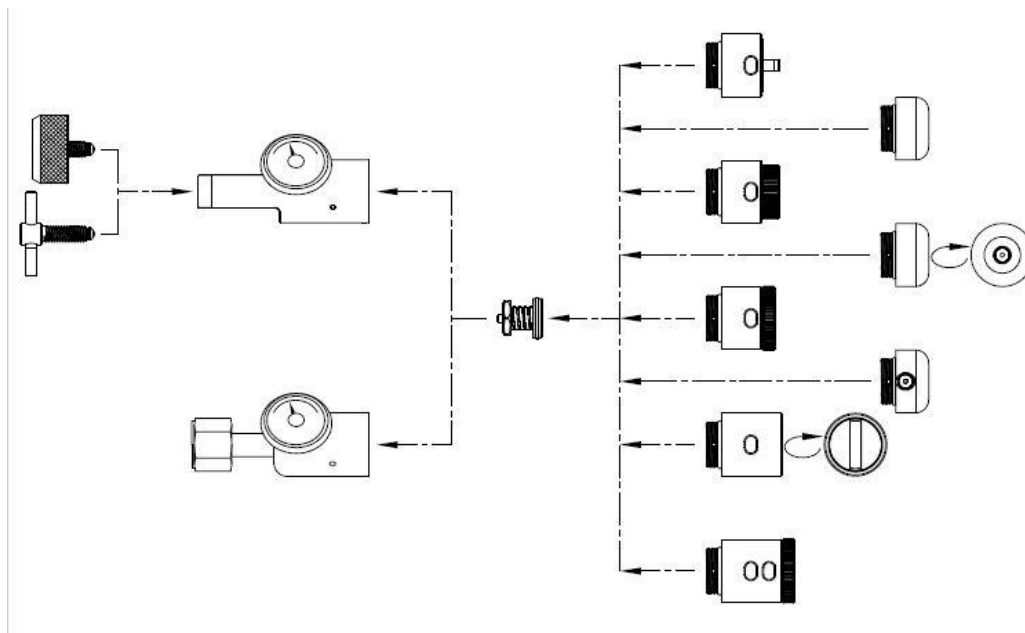

----- FLOW CARTRIDGE CONFIGURATION:

- 1 - Tang Knob
- 2 - Large Diameter Knurled Knob
- 3 - Small Diameter Knurled Knob
- 4 - Double Window Large Knurled Knob
- 5 - Shrouded Knob
- 6 - Cap

----- COLOR OPTION:

- NONE - Green Anodized Body
- 1 - Lt Blue Anodized Body
- 2 - Silver Anodized Body
- 4 - Yellow Anodized Body
- 5 - Blue Anodized Body
- 6 - Red Anodized Body
- 7 - Brown Anodized Body
- 8 - Gold Anodized Body
- 9 - Black Anodized Body
- A - Purple Anodized Body
- B - Orange Anodized Body
- G - Gold Plated Brass Body (No Aluminum)
- T - Tri-Metal Plated Brass Body (No Aluminum)

----- WINDOW & CONTROLLED FLOW OUTLET POSITIONS:

- 0 - Window @ 0 & Hose Barb @ 180
- 1 - Window @ 0 & DISS-1240 Fitting @ 180
- 2 - Window @ 0 & 1/8" Female Pipe Port @ 180
- 4 - Window @ 270 & Hose Barb @ 180
- 5 - Window @ 270 & DISS-1240 Fitting @ 180
- 6 - Window @ 270 & 1/8" Female Pipe Port @ 180
- 7 - Window @ 0 & Hose Barb @ 0
- 8 - Window @ 90 & Hose Barb @ 180
- 9 - Window @ 90 & DISS-1240 Fitting @ 180
- A - Window @ 90 & 1/8" Female Pipe Port @ 180
- C - Window @ 0 & DISS-1160 Fitting @ 180
- D - Window @ 270 & DISS-1160 Fitting @ 180
- E - Window @ 270 & DISS-1240 Fitting w/ 1/8" BSPP @ 180
- F - Window @ 0 & 1/4" Hose Barb @ 180
- G - Window @ 0 & DISS-1080 Fitting @ 180
- H - Window @ 0 & Clear Hose Barb @ 180
- N - Window @ 0 & DISS-1240 Fitting & Barb Nipple @ 180
- S - Window @ 0 & Stainless Steel Hose Barb @ 180
- U - Window @ 0 & Universal Adapter @ 180
- X - Window @ 180 & 1/8" Female Pipe Port @ 180

-OR-

CAP OUTLET POSITIONS:

- 0 - Outlet on Centerline
- 2 - Outlet @ 0
- 3 - Outlet @ 90
- 6 - Outlet @ 180
- 9 - Outlet @ 270

----- INLET CONNECTION:

- 1 - CGA 580 Hex Nut & Nipple Assembly (Nitrogen)
- 2 - 1/4" Female Pipe Port
- 3 - CGA 973 Yoke Assembly (Medical Gas Mix)
- 4 - CGA 346 Hex Nut & Nipple Assembly (Medical Air)
- 5 - CGA 540 Hex Nut & Nipple Assembly (Oxygen)
- 6 - CGA 965 Yoke Swivel Body (Nitrous Oxide/Oxygen Mix)
- 7 - CGA 940 Yoke Assembly (Carbon Dioxide >7%/Oxygen Mix)
- 8 - CGA 870 Yoke Unibody (Oxygen)
- 9 - CGA 950 Yoke Unibody (Medical Air)
- A - CGA 500 Hex Nut & Nipple Assembly (Medical Gas Mix)
- B - CGA 280 Hex Nut & Nipple Assembly (Helium 80%/Oxygen 20% Mix)
- C - CGA 320 Hex Nut & Nipple Assembly (Carbon Dioxide)
- D - CGA 960 Yoke Assembly (Nitrogen)
- E - British Standard Nut & Nipple BS 341 # 3 (Oxygen)
- F - Tipo "F" Nut & Nipple (Oxygen) (discontinued)
- G - DIN 477-9 Nut & Nipple (Oxygen)
- H - Face Mount (discontinued)
- J - CGA 910 Unibody (Nitrous Oxide) (discontinued)
- K - CGA 930 Yoke Assembly (Helium)
- L - CGA 880 Yoke Assembly (Carbon Dioxide < 7%/Oxygen Mix)
- M - CGA 890 Yoke Assembly (Heliox 80%/Oxygen 20 Mix) (discontinued)
- N - CGA 660 Nut & Nipple (Nitric Oxide)
- R - CGA 626 Hex Nut & Nipple (Nitric Oxide Mix)
- S - CGA 626 Knurled Nut & Nipple (Nitric Oxide Mix)
- W - Swedish Standard 36 76 15 annex E1 (Oxygen) (discontinued)
- X - CGA 326 Nut & Nipple (Nitrous Oxide) (discontinued)
- T - CGA 280 Knurled Nut & Nipple (Carbon Dioxide < 7%/Oxygen Mix)
- U - CGA 540 Knurled Nut & Nipple Assembly (Oxygen)

----- GAUGE & BODY CONFIGURATIONS:

- A - RH, 1.4", 3000 PSI Gauge @ 0 degrees
- B - LH, 1.4", 3000 PSI Gauge @ 60 degrees, Reverse Pins
- C - RH Gauge Port @ 300 degrees, Plugged
- D - RH, 1.6", 3000 PSI Gauge @ 300 degrees
- E - RH, 1.4", 3000 PSI Gauge @ 300 degrees, Upside Down
- F - RH, 1.4", 3000 PSI Gauge @ 300 degrees, Overpressure
- G - LH, 1.6", 21 mPa / 3000 PSI Gauge @ 60 degrees
- H - RH, 1.6", 21 mPa / 3000 PSI Gauge @ 300 degrees
- J - RH, 1.6" 3000 PSI Stainless Steel Gauge, @ 300 degrees
- K - LH, No Gauge
- L - LH, 1.4", 3000 PSI Gauge @ 60 degrees
- M - LH, 1.4", 3000 PSI Gauge @ 90 degrees
- N - RH, 1.6", 3000 PSI Gauge @ 300 degrees, Plain Face
- P - LH Gauge Port @ 60 & RH 1.6", 3000 PSI Stainless Steel Gauge @ 300
- Q - RH, 1.4", 3000 PSI Gauge @ 270 degrees
- R - RH, 1.4", 3000 PSI Gauge @ 300 degrees
- S - RH, No Gauge
- T - LH Gauge Port @ 60 & RH Gauge Port @ 300
- V - LH, 1.4", 3000 PSI Gauge @ 60 degrees, Upside Down
- W - RH, 1.4", 3000 PSI Gauge @ 300 degrees, Reverse Pins
- X - RH, 1.4", 4000 PSI Gauge @ 270 degrees, Plain Face
- Y - RH, 1.4", 3000 PSI Gauge @ 300 & DISS-1240 N & N @ 60
- Z - RH, 1.4", 3000 PSI Gauge @ 300 & 1/8" to 1/4" Adapter @ 60 degrees

----- PRODUCT GROUP:
R - Regulator

FLOW RANGE:

See B-Flows chart for part number and list price

COLOR OPTION:

- NONE - Green Anodized Body
- 1 - Lt Blue Anodized Body
- 2 - Silver Anodized Body
- 4 - Yellow Anodized Body
- 5 - Blue Anodized Body
- 6 - Red Anodized Body
- 7 - Brown Anodized Body
- 8 - Gold Anodized Body
- 9 - Black Anodized Body
- A - Purple Anodized Body
- B - Orange Anodized Body
- G - Gold Plated Brass Body (No Aluminum)
- T - Tri-Metal Plated Brass Body (No Aluminum)

-OR-

FITTING OUTLET:

- A - 1 LPM Orifice
- B - 2 LPM Orifice
- C - 3 LPM Orifice
- D - 4 LPM Orifice
- E - 5 LPM Orifice
- F - 6 LPM Orifice
- H - 8 LPM Orifice
- J - 10 LPM Orifice
- L - 12 LPM Orifice
- M - 15 LPM Orifice
- N - 20 LPM Orifice
- P - 25 LPM Orifice
- T - 60 LPM Orifice
- V - 70 LPM Orifice
- W - 1/2 LPM Orifice (discontinued)
- Y - 1/4 LPM Orifice

FLOW CARTRIDGE OPTIONS:

- 0 - No Flow Cartridge Options
- 2 - 2 Position
- 4 - 4 Position
- 5 - 5 Position
- 8 - 8 Position
- A - 20 PSI Outlet Pressure
- B - 125 PSI Outlet Pressure
- C - 250 PSI Outlet Pressure
- D - 30 PSI Outlet Pressure
- F - 58 PSI Outlet Pressure
- G - 40 PSI Outlet Pressure (discontinued)
- H - 24 PSI Outlet Pressure
- K - 20 PSI Outlet Pressure @ 3000 PSI Inlet Pressure
- M - 110 PSI Outlet Pressure
- Q - High Flow @ 90 PSI
- S - Stainless Steel Body & Knob
- V - 17 PSI Outlet Pressure
- Z - High Flow @ 70 PSI

-OR-

CAP OPTIONS:

- 0 - Plain Cap, No Outlets
- 1 - Hose Barb 1/8" MNPT
- 2 - 1/8" FNPT
- 4 - 3/16" Female SAE Boss Port
- 5 - DISS-2020 Fitting
- 6 - Hose Barb 3/16" SAE Boss
- 7 - DISS-1240 Fitting
- 8 - 1/4" FNPT
- 9 - Plain Cap (short), No Outlets
- A - DISS-1160 Fitting
- B - One DISS-1240 Check Valve
- C - One DISS-1160 Check Valve
- D - Outlet Pressure Gauge
- E - DISS-1240 Check Valve mounted on AF212-2-2 @ 60 degrees
- H - Hansen QD
- P - Puritain Bennett QD
- S - Stainless Steel Body w/ 1/8" FNPT

BODY OPTION(S):

- 0 - No Body Options
- 1 - C-Clip on T-Handle or Nipple
- 2 - Plastic Knob on Hex Nut (Hand Tight)
- 3 - Dome-Handle
- 4 - Dome-Handle & Long Body
- 5 - Dome-Handle & 20 PSI Outlet Pressure
- 6 -
- 7 - Long Body
- 8 - Long Nipple
- 9 - Aluminum PR-50
- A - 20 PSI Outlet Pressure
- B - 125 PSI Outlet Pressure
- C - 250 PSI Outlet Pressure
- D - 30 PSI Outlet Pressure
- E - Tamper Resistant Stem
- F - 58 PSI Outlet Pressure
- G - 40 PSI Outlet Pressure (discontinued)
- H - 24 PSI Outlet Pressure
- J - Jam Nut Thread Insert
- K - 20 PSI Outlet Pressure @ 3000 PSI Inlet Pressure
- L - Large Stainless Steel T-Handle
- M - 110 PSI Outlet Pressure
- N - Short Nipple
- P - Swivel Yoke (InGage Style) & 58 PSI Outlet Pressure
- Q - High Flow @ 90 PSI
- R - Tamper Resistant Socket
- S - Stainless Steel Body
- T - Large T-Handle & 17 PSI Outlet Pressure
- U - Long Body & Large T-Handle
- V - 17 PSI Outlet Pressure
- W - Plastic Knob on Hex Nut (Hand Tight) & 20 PSI Outlet Pressure
- Y - Swivel Yoke (InGage Style)
- Z - High Flow @ 70 PSI

PRESSURE REDUCED BODY OUTLET(S):

- 0 - No Pressure Body Outlets
- 1 - One DISS-1240 Check Valve
- 2 - One 1/8" FNPT (Plugged)
- 3 - Two DISS-1240 Check Valves
- 4 - Two 1/8" FNPT (Plugged)
- 5 - Two 1/4" Female SAE Ports (Plugged)
- 6 - One DISS-1240 Check Valve & One 1/8" FNPT (Plugged)
- 7 - One DISS-1160 Check Valve
- 8 - Two 1/4" FNPT (Plugged)
- 9 - Two DISS-1240 Check Valves w/ 1/4" FNPT
- A - Two DISS-1160 Check Valves
- B - One Hose Barb with 6 LPM Orifice
- C - Two DISS-1160 Check Valves w/ 1/4" FNPT
- D - One DISS-1120 Check Valve
- E - One Female Ohio QD & One DISS-1240 Check Valve
- F - One Female Ohio QD & One DISS-1240 Check Valve w/ 1/4" FNPT
- G - One Female Ohio QD (Medical Air)
- H - One Female Ohio QD
- J - One Hose Assembly w/ Male Ohio w/check valve (Oxygen)
- K - One Long Australian SIS Check Valve & One Short Australian SIS Check Valve
- L - One Long Australian SIS Check Valve
- M - One DISS-1040 Check Valve
- N - Two 1/8" FNPT @ 90 degree spread (Plugged)
- P - Two DISS-1240 Check Valves w/ One HBD2-50-10
- Q - One Female Chemetron QD & One DISS-1240 Check Valve
- R - Hansen QD
- S - One DISS-1060 Check Valve
- T - One Female Chemetron QD
- U - One Hansen QD & One DISS-1240 Check Valve
- V - One 1/8" FNPT (Plugged) @ 180
- W - One DISS-1180 Check Valve
- X - One Female Ohio QD (ISO White) & One DISS-1240 Check Valve w/ 1/4" FNPT
- Y - Male Hansen QD mounted on an AF212-2-2, 90 degree elbow

REGULATOR SINGLE WINDOW

M-Flow Range Codes, Regulators (2020-10-06).xlsx.pdf

FLOW RANGE	RANGE CODE	FLOW SETTINGS AS THEY APPEAR THRU WINDOW											SAE
1/10 thru 1.5	A1	0.1	0.2	0.3	0.4	0.5	0.6	0.7	0.8	0.9	1	1.5	A4
1/10 thru 1.5 @ 20 PSI	A1	0.1	0.2	0.3	0.4	0.5	0.6	0.7	0.8	0.9	1	1.5	A4
1/50 thru 3	A5	0.02	0.03	0.05	0.08	0.12	0.2	0.3	0.5	0.75	1	3	
1/50 thru 3 @ 58 PSI	A5	0.02	0.03	0.05	0.08	0.12	0.2	0.3	0.5	0.75	1	3	
1/40 thru 2	B1	0.025	0.04	0.06	0.09	0.15	0.25	0.4	0.6	0.9	1.5	2	
1/32 thru 4	D2	1/32	1/16	1/8	1/4	1/2	3/4	1	1 1/2	2	3	4	D1
1/16 thru 4	D4	0.06	0.12	0.25	0.5	0.75	1	1.5	2	2.5	3	4	
1/32 thru 5	E1	0.03	0.06	0.12	0.25	0.5	1	1.5	2	3	4	5	
1/8 thru 6	F1	0.12	0.25	0.5	0.75	1	1.5	2	3	4	5	6	
1/2 thru 8	H1	0.5	1	1.5	2	2.5	3	4	5	6	7	8	H3
1/2 thru 8 @ 20 PSI	H1	0.5	1	1.5	2	2.5	3	4	5	6	7	8	
1/2 thru 10	J1	0.5	1	1.5	2	2.5	3	4	5	6	8	10	
6 thru 12	L4	-	6	-	12	-	-	-	-	-	-	-	
1/2 thru 15	M1	0.5	1	1.5	2	3	4	5	6	8	10	15	M3
1/2 thru 15 @ 58 PSI	M1	0.5	1	1.5	2	3	4	5	6	8	10	15	M3
1/2 thru 15	M5	0.5	1	2	3	4	5	6	8	10	12	15	M7
1/32 thru 15	M6	1/32	1/16	1/8	1/4	1/2	3/4	1	1 1/2	2	6	15	M4
1/4 thru 15	MB	1/4	1/2	1	1 1/2	2	3	4	6	8	12	15	M8
1/32 thru 15	MC	A	B	C	D	E	F	G	H	I	J	K	M4
8 thru 15 @ 58 PSI	MD	8	15	-	-	-	-	-	-	-	-	-	
6 thru 12	MX	FLOW	CPR	-	-	-	-	-	-	-	-	-	
1/4 thru 25	P1	0.25	0.5	1	2	3	4	6	8	10	15	25	P3
1/4 thru 25	P2	1/4	1/2	1	2	3	4	6	8	10	15	25	P3
1/4 thru 25 @ 58 PSI	P2	1/4	1/2	1	2	3	4	6	8	10	15	25	
1 thru 25	P4	1	2	3	4	6	8	10	12	15	20	25	P6
1 thru 25 @ 20 PSI	P4	1	2	3	4	6	8	10	12	15	20	25	P6
1 thru 25 @ 70 PSI	P4	1	2	3	4	6	8	10	12	15	20	25	P6
1 thru 25 @ 70 PSI /5	P4	1	2	3	4	6	8	10	12	15	20	25	P6
1 thru 25	P5	1	2	3	4	5	6	8	10	12	15	25	PB
1/2 thru 25	P7	1/2	1	1 1/2	2	3	4	6	8	10	15	25	P8
8 thru 25	PA	8	12	15	25	-	-	-	-	-	-	-	
	PE	1/4	1/2	1	2	4	6	8	10	15	20	25	
1/2 thru 30	PD	1/2	2	4	6	8	10	12	15	20	25	30	PC
3 thru 25	PL	3	4	5	6	7	8	10	12	15	20	25	
3 thru 25 @ 70 PSI	PL	3	4	5	6	7	8	10	12	15	20	25	
1/4 thru 30	Q1	0.25	0.5	1	2	4	6	8	10	12	20	30	
4 thru 40	Q7	4	6	8	10	12	15	20	25	30	35	40	
1 thru 60	T1	1	2	3	4	5	6	10	15	25	40	60	

REGULATOR DOUBLE WINDOW

FLOW RANGE	RANGE CODE	FLOW SETTINGS AS THEY APPEAR THRU WINDOW											SAE
25 ML thru 1 L	A2	25	50	75	100	125	150	175	200	250	500	1	
		ML	ML	ML	ML	ML	ML	ML	ML	ML	ML	L	
25 CC thru 3 L	A6	25	50	100	150	200	250	500	1	1.5	2	3	
		CC	CC	CC	CC	CC	CC	CC	L	L	L	L	
20 ML thru 3 L	C4	20	25	50	100	250	500	750	1	1.5	2	3	
		ML	ML	ML	ML	ML	ML	ML	L	L	L	L	
30 ML thru 4 L	D8	30	60	125	250	500	750	1	1.5	2	3	4	D7
		ML	ML	ML	ML	ML	ML	L	L	L	L	L	